

STEERING ANGLE SENSOR CONSTRUCTION/OPERATION

B3E041543000T07

Construction/Operation

- The steering angle sensor has a sensor unit with a photo transistor positioned opposite an LED straddling a slitted disc that moves together with the steering wheel.
- As the disc moves with the steering wheel, the LED light received by the photo transistor varies due to the slits on the disc. The photo transistor outputs an on signal when it receives light and an off signal when the light is blocked. The DSC HU/CM calculates the steering angle and speed based on the phase difference between sensor A and B outputs.

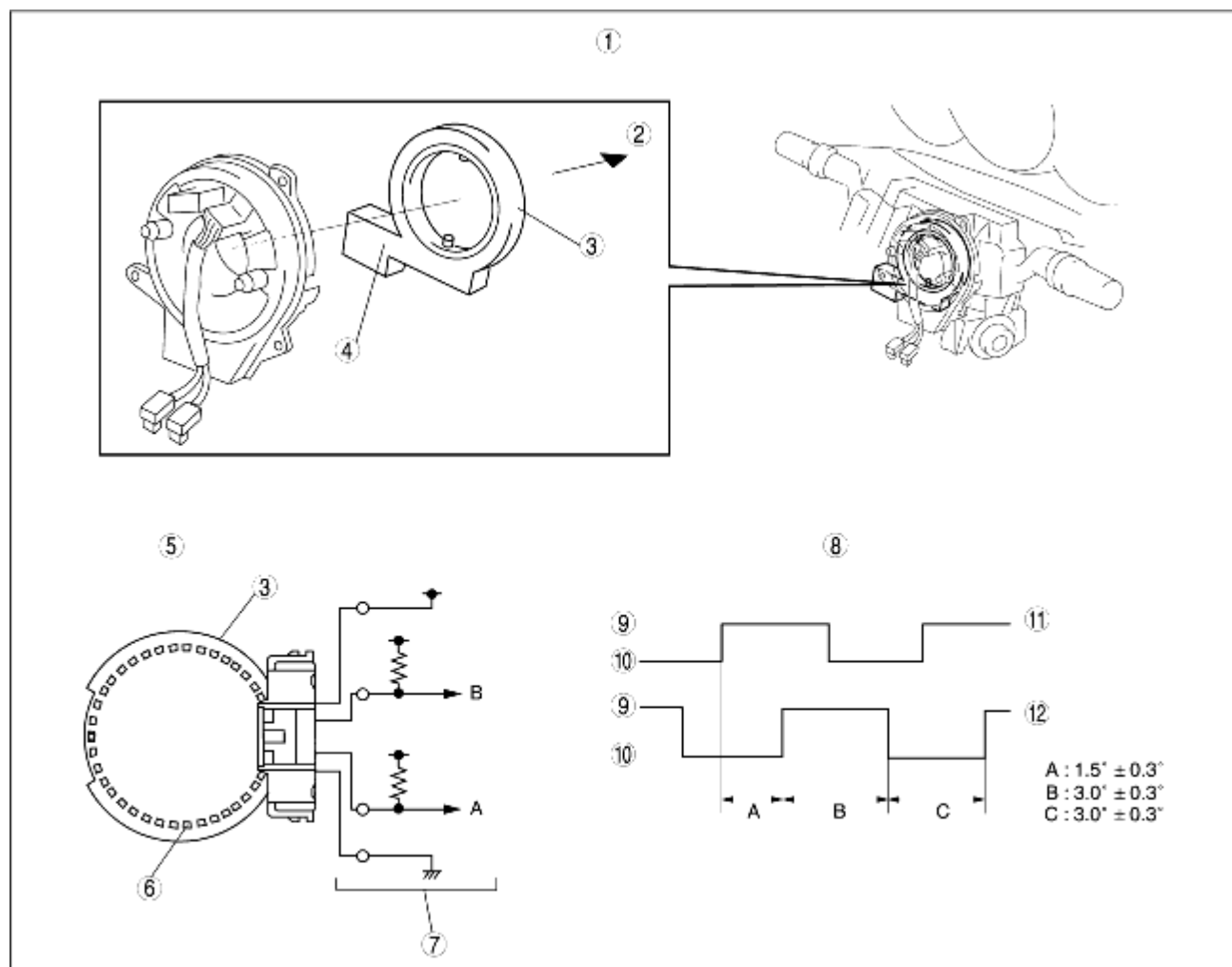

B3E04 15T012

1	Installation position
2	Vehicle front
3	Disc
4	Sensor unit

5	Structural view
6	Slit
7	Detection circuit (inside DSC HU/CM)
8	Output wave pattern
9	On
10	Off
11	Sensor B (steering angle signal B)
12	Sensor A (steering angle signal A)